

# SEPA ENVIRONMENTAL CHECKLIST

## ***Purpose of checklist:***

Governmental agencies use this checklist to help determine whether the environmental impacts of your proposal are significant. This information is also helpful to determine if available avoidance, minimization or compensatory mitigation measures will address the probable significant impacts or if an environmental impact statement will be prepared to further analyze the proposal.

## ***Instructions for applicants:***

This environmental checklist asks you to describe some basic information about your proposal. Please answer each question accurately and carefully, to the best of your knowledge. You may need to consult with an agency specialist or private consultant for some questions. You may use "not applicable" or "does not apply" only when you can explain why it does not apply and not when the answer is unknown. You may also attach or incorporate by reference additional studies reports. Complete and accurate answers to these questions often avoid delays with the SEPA process as well as later in the decision-making process.

The checklist questions apply to all parts of your proposal, even if you plan to do them over a period of time or on different parcels of land. Attach any additional information that will help describe your proposal or its environmental effects. The agency to which you submit this checklist may ask you to explain your answers or provide additional information reasonably related to determining if there may be significant adverse impact.

## ***Instructions for Lead Agencies:***

Please adjust the format of this template as needed. Additional information may be necessary to evaluate the existing environment, all interrelated aspects of the proposal and an analysis of adverse impacts. The checklist is considered the first but not necessarily the only source of information needed to make an adequate threshold determination. Once a threshold determination is made, the lead agency is responsible for the completeness and accuracy of the checklist and other supporting documents.

## ***Use of checklist for nonproject proposals:***

For nonproject proposals (such as ordinances, regulations, plans and programs), complete the applicable parts of sections A and B plus the [SUPPLEMENTAL SHEET FOR NONPROJECT ACTIONS \(part D\)](#). Please completely answer all questions that apply and note that the words "project," "applicant," and "property or site" should be read as "proposal," "proponent," and "affected geographic area," respectively. The lead agency may exclude (for non-projects) questions in Part B - Environmental Elements –that do not contribute meaningfully to the analysis of the proposal.

## **A. Background**

1. Name of proposed project, if applicable:  
[Deaconess Work Release \(Wenatchee\)](#)
2. Name of applicant:  
[Department of Corrections](#)

3. Address and phone number of applicant and contact person:

Eric Heinitz  
PO Box 41112, Olympia, WA 98504-1112  
360-790-9341

4. Date checklist prepared:

26 APR 2021

5. Agency requesting checklist:

Department of Corrections

6. Proposed timing or schedule (including phasing, if applicable):

Estimated schedule:

Design and Land-Use entitlement (8 months)

- Initiate design and land-use review process
- Apply for required land-use entitlement reviews, approvals

Building Permit (3 months)

- Apply for required engineering and building reviews, approvals and permits (3 months).

Construction (9 months)

Occupancy (2 months)

**Total estimated time – (22 months)**

7. Do you have any plans for future additions, expansion, or further activity related to or connected with this proposal? If yes, explain.

No

8. List any environmental information you know about that has been prepared, or will be prepared, directly related to this proposal.

None, this is an internal renovation and update of an existing building with no external expansion or changes to the structures or surrounding area.

9. Do you know whether applications are pending for governmental approvals of other proposals directly affecting the property covered by your proposal? If yes, explain.

No

10. List any government approvals or permits that will be needed for your proposal, if known.

City of Wenatchee land use and building approvals and permits.

11. Give brief, complete description of your proposal, including the proposed uses and the size of the project and site. There are several questions later in this checklist that ask you to describe certain aspects of your proposal. You do not need to repeat those answers on this page. (Lead agencies may modify this form to include additional specific information on project description.)

This project is a renovation of the South Wing of an existing building (formerly Deaconess Hospital) being leased by the Department of Corrections for use as a Work Release. The building when completed and put into use will house up to 82 work release offenders and 28 staff.

12. Location of the proposal. Give sufficient information for a person to understand the precise location of your proposed project, including a street address, if any, and section, township, and range, if known. If a proposal would occur over a range of area, provide the range or boundaries of the site(s). Provide a legal description, site plan, vicinity map, and topographic map, if reasonably available. While you should submit any plans required by the agency, you are not required to duplicate maps or detailed plans submitted with any permit applications related to this checklist.

300 Okanagon Ave. (South Wing), Wenatchee WA 98801  
 (Parcel # 222010530010, 222010530020 & 222010530001)

Tax Area: W246 F1

Township: 22N                      Section: 10  
 Range: 20EWM                      Legal Acres: 1.7500  
 Green area is proposed area for development:

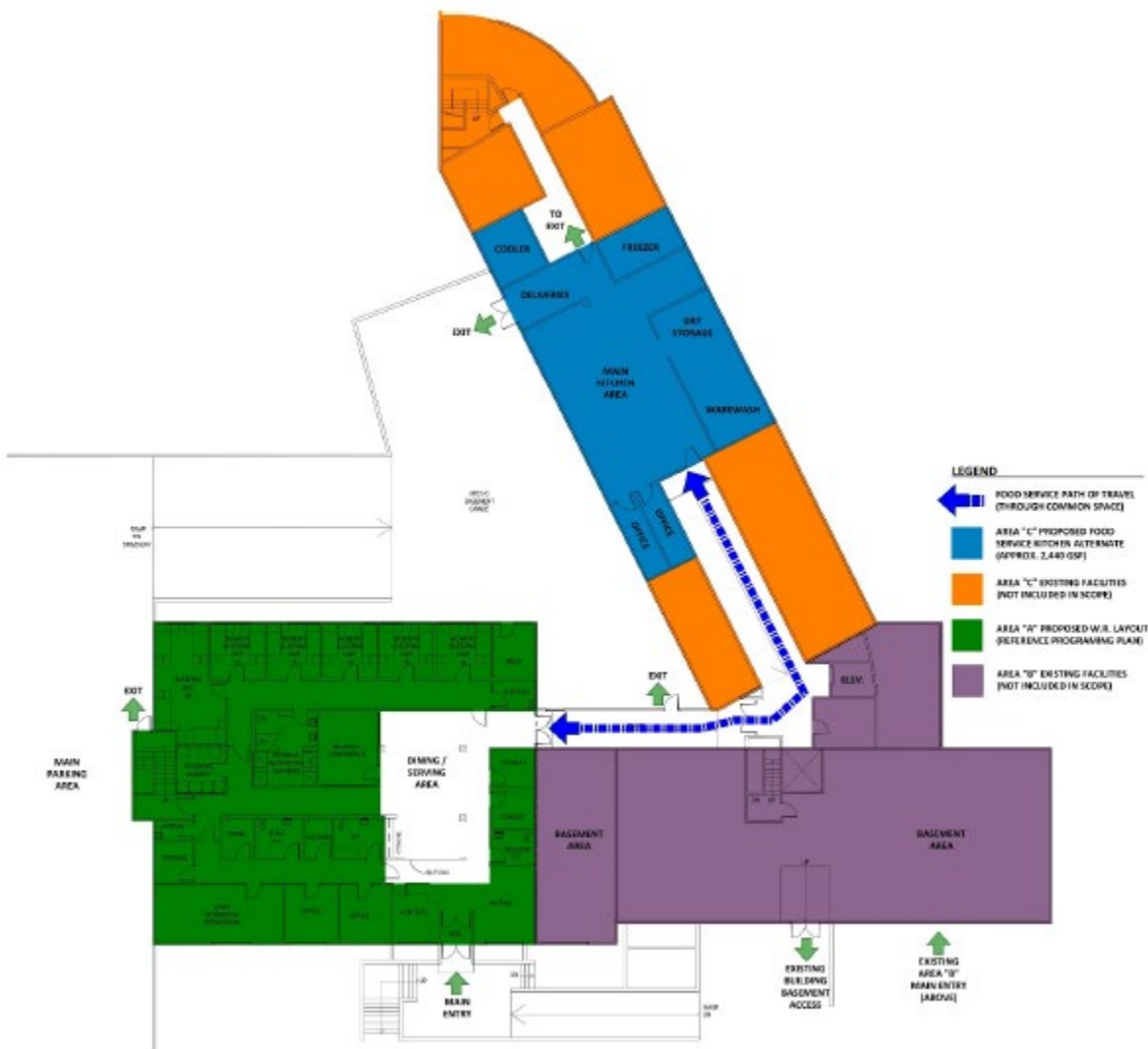

PROPOSED WORK RELEASE FACILITY - OVERALL LAYOUT

## B. ENVIRONMENTAL ELEMENTS

### 1. Earth

a. General description of the site:

(circle one) **Flat**, rolling, hilly, steep slopes, mountainous, other \_\_\_\_\_

b. What is the steepest slope on the site (approximate percent slope)? **N/A**

c. What general types of soils are found on the site (for example, clay, sand, gravel, peat, muck)? If you know the classification of agricultural soils, specify them and note any agricultural land of long-term commercial significance and whether the proposal results in removing any of these soils. **N/A**

d. Are there surface indications or history of unstable soils in the immediate vicinity? If so, describe. **N/A**

e. Describe the purpose, type, total area, and approximate quantities and total affected area of any filling, excavation, and grading proposed. Indicate source of fill.  
**None.**

f. Could erosion occur as a result of clearing, construction, or use? If so, generally describe.  
**N/A**

g. About what percent of the site will be covered with impervious surfaces after project construction (for example, asphalt or buildings)?  
**No proposed change to impervious surfaces.**

h. Proposed measures to reduce or control erosion, or other impacts to the earth, if any: **N/A**

### 2. Air

a. What types of emissions to the air would result from the proposal during construction, operation, and maintenance when the project is completed? If any, generally describe and give approximate quantities if known.  
**Emissions from delivery trucks and construction vehicles during the renovations. No emissions after project is complete.**

b. Are there any off-site sources of emissions or odor that may affect your proposal? If so, generally describe. **None**

c. Proposed measures to reduce or control emissions or other impacts to air, if any: **N/A**

### 3. Water

a. Surface Water:

1) Is there any surface water body on or in the immediate vicinity of the site (including year-round and seasonal streams, saltwater, lakes, ponds, wetlands)? If yes, describe type and provide names. If appropriate, state what stream or river it flows into.

None

2) Will the project require any work over, in, or adjacent to (within 200 feet) the described waters? If yes, please describe and attach available plans.

No

3) Estimate the amount of fill and dredge material that would be placed in or removed from surface water or wetlands and indicate the area of the site that would be affected. Indicate the source of fill material.

N/A

4) Will the proposal require surface water withdrawals or diversions? Give general description, purpose, and approximate quantities if known.

No

5) Does the proposal lie within a 100-year floodplain? If so, note location on the site plan.

No

6) Does the proposal involve any discharges of waste materials to surface waters? If so, describe the type of waste and anticipated volume of discharge.

No

b. Ground Water:

1) Will groundwater be withdrawn from a well for drinking water or other purposes? If so, give a general description of the well, proposed uses and approximate quantities withdrawn from the well. Will water be discharged to groundwater? Give general description, purpose, and approximate quantities if known.

No

2) Describe waste material that will be discharged into the ground from septic tanks or other sources, if any (for example: Domestic sewage; industrial, containing the following chemicals. . . ; agricultural; etc.). Describe the general size of the system, the number of such systems, the number of houses to be served (if applicable), or the number of animals or humans the system(s) are expected to serve.

N/A

c. Water runoff (including stormwater):

1) Describe the source of runoff (including storm water) and method of collection and disposal, if any (include quantities, if known). Where will this water flow? Will this water flow into other waters? If so, describe.

No change in existing conditions.

2) Could waste materials enter ground or surface waters? If so, generally describe.

No

3) Does the proposal alter or otherwise affect drainage patterns in the vicinity of the site? If so, describe.

No

d. Proposed measures to reduce or control surface, ground, and runoff water, and drainage pattern impacts, if any:

N/A

#### 4. Plants

a. Check the types of vegetation found on the site:

\_\_\_deciduous tree: alder, maple, aspen, other

\_\_\_evergreen tree: fir, cedar, pine, other

\_\_\_shrubs

\_\_\_grass

\_\_\_pasture

\_\_\_crop or grain

\_\_\_ Orchards, vineyards or other permanent crops.

\_\_\_ wet soil plants: cattail, buttercup, bullrush, skunk cabbage, other

\_\_\_water plants: water lily, eelgrass, milfoil, other

\_\_\_other types of vegetation

b. What kind and amount of vegetation will be removed or altered?

N/A

c. List threatened and endangered species known to be on or near the site.

N/A

d. Proposed landscaping, use of native plants, or other measures to preserve or enhance vegetation on the site, if any:

Meet City requirements for street trees and landscaping.

e. List all noxious weeds and invasive species known to be on or near the site.

N/A

#### 5. Animals

a. List any birds and other animals which have been observed on or near the site or are known to be on or near the site.

Examples include:

birds: hawk, heron, eagle, songbirds, other:

mammals: deer, bear, elk, beaver, other:

fish: bass, salmon, trout, herring, shellfish, other \_\_\_\_\_

b. List any threatened and endangered species known to be on or near the site.

N/A

c. Is the site part of a migration route? If so, explain.

N/A

d. Proposed measures to preserve or enhance wildlife, if any:

N/A

e. List any invasive animal species known to be on or near the site.

N/A

## 6. Energy and Natural Resources

a. What kinds of energy (electric, natural gas, oil, wood stove, solar) will be used to meet the completed project's energy needs? Describe whether it will be used for heating, manufacturing, etc.

Electric and Natural Gas

b. Would your project affect the potential use of solar energy by adjacent properties? If so, generally describe.

No

c. What kinds of energy conservation features are included in the plans of this proposal?

List other proposed measures to reduce or control energy impacts, if any:

Proposed development will be remodeled to meet DES Leased Space Requirements :

<https://des.wa.gov/sites/default/files/public/documents/Facilities/RES/MarketSearches/1001583/>

[AppA-SpaceRequirements.pdf](#)

## 7. Environmental Health

a. Are there any environmental health hazards, including exposure to toxic chemicals, risk of fire and explosion, spill, or hazardous waste, that could occur as a result of this proposal? If so, describe.

1) Describe any known or possible contamination at the site from present or past uses.

No known contaminants

2) Describe existing hazardous chemicals/conditions that might affect project development and design. This includes underground hazardous liquid and gas transmission pipelines located within the project area and in the vicinity.

No known hazards

3) Describe any toxic or hazardous chemicals that might be stored, used, or produced during the project's development or construction, or at any time during the operating life of the project.

None that will be allowed by DOC

4) Describe special emergency services that might be required.

None

5) Proposed measures to reduce or control environmental health hazards, if any:

N/A

b. Noise

1) What types of noise exist in the area which may affect your project (for example: traffic, equipment, operation, other)?

None

2) What types and levels of noise would be created by or associated with the project on a short-term or a long-term basis (for example: traffic, construction, operation, other)? Indicate what hours noise would come from the site.

Minimal and temporary construction noise

3) Proposed measures to reduce or control noise impacts, if any:

N/A

**8. Land and Shoreline Use**

a. What is the current use of the site and adjacent properties? Will the proposal affect current land uses on nearby or adjacent properties? If so, describe.

Commercial Use

The project will have no effect on current land uses or adjacent properties.

b. Has the project site been used as working farmlands or working forest lands? If so, describe. How much agricultural or forest land of long-term commercial significance will be converted to other uses as a result of the proposal, if any? If resource lands have not been designated, how many acres in farmland or forest land tax status will be converted to nonfarm or nonforest use?

N/A

1) Will the proposal affect or be affected by surrounding working farm or forest land normal business operations, such as oversize equipment access, the application of pesticides, tilling, and harvesting? If so, how:

N/A

c. Describe any structures on the site.

300 Okanogan's original building was constructed in 1924 to serve as the Deaconess Hospital. Subsequent additions were constructed in 1948 (South Wing) and 1961 Area C (East Wing). The south wing (Area A) is currently a vacant 13,141 square-foot, concrete structure with (2) floors and a mechanical penthouse. The existing occupied commercial space (Area B) is equipped with an elevator. It is proposed that the new WR facility 2nd floor at Unit A will share the elevator with the commercial occupancy. Area A is not currently sprinkled; however, Areas B and C are fully sprinkled. The south wing was designed and constructed in 1948 and any work to the wing would fall under the 2018 edition of the International Existing Building Code (IEBC) in addition to other adopted codes. With the proposed use of this wing being an R-2 occupancy and constituting a change of use and occupancy, at a minimum a 2-hour rated occupancy separation will



a B.

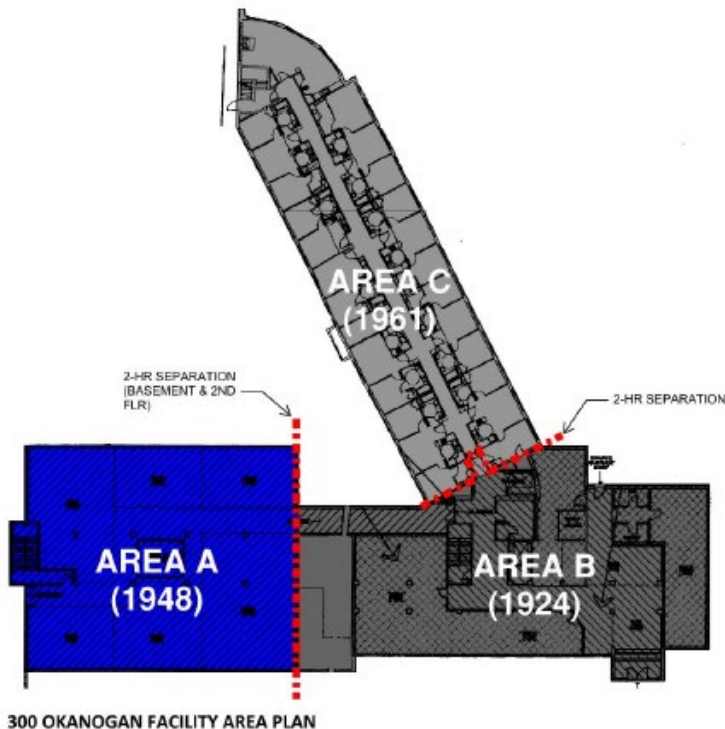

d. Will any structures be demolished? If so, what?

No

e. What is the current zoning classification of the site?

The property is zoned Residential Moderate (RM).

f. What is the current comprehensive plan designation of the site?

Based on preliminary discussions with the AHJ, a DOC work/training release facility is considered a Conditional Use in the RM zone and is designated an Essential Public Facility (EPF).

g. If applicable, what is the current shoreline master program designation of the site?

N/A

h. Has any part of the site been classified as a critical area by the city or county? If so, specify.

No

i. Approximately how many people would reside or work in the completed project?

Total 110 (Residents 82, workers 28).

j. Approximately how many people would the completed project displace?

None

k. Proposed measures to avoid or reduce displacement impacts, if any:

N/A

L. Proposed measures to ensure the proposal is compatible with existing and projected land uses and plans, if any:

This project is occupying an existing structure and the use is similar to the previous building use. The current use as a Work Release is compatible with existing uses and commercial businesses in the area.

m. Proposed measures to ensure the proposal is compatible with nearby agricultural and forest lands of long-term commercial significance, if any:

N/A

## 9. Housing

a. Approximately how many units would be provided, if any? Indicate whether high, middle, or low-income housing.

This project will house up to 82 work release offenders.

b. Approximately how many units, if any, would be eliminated? Indicate whether high, middle, or low-income housing.

None

c. Proposed measures to reduce or control housing impacts, if any:

N/A

## 10. Aesthetics

a. What is the tallest height of any proposed structure(s), not including antennas; what is the principal exterior building material(s) proposed?

Height N/A. Proposed exterior building materials are unknown, likely no change to existing.

b. What views in the immediate vicinity would be altered or obstructed?

None

c. Proposed measures to reduce or control aesthetic impacts, if any:

N/A

## 11. Light and Glare

a. What type of light or glare will the proposal produce? What time of day would it mainly occur?

N/A

b. Could light or glare from the finished project be a safety hazard or interfere with views?

N/A

c. What existing off-site sources of light or glare may affect your proposal?

No

d. Proposed measures to reduce or control light and glare impacts, if any:

N/A

## 12. Recreation

- a. What designated and informal recreational opportunities are in the immediate vicinity?

None

- b. Would the proposed project displace any existing recreational uses? If so, describe.

No

- c. Proposed measures to reduce or control impacts on recreation, including recreation opportunities to be provided by the project or applicant, if any:

N/A

## 13. Historic and cultural preservation

- a. Are there any buildings, structures, or sites, located on or near the site that are over 45 years old listed in or eligible for listing in national, state, or local preservation registers located on or near the site? If so, specifically describe.

No

- b. Are there any landmarks, features, or other evidence of Indian or historic use or occupation? This may include human burials or old cemeteries. Are there any material evidence, artifacts, or areas of cultural importance on or near the site? Please list any professional studies conducted at the site to identify such resources.

No

- c. Describe the methods used to assess the potential impacts to cultural and historic resources on or near the project site. Examples include consultation with tribes and the department of archeology and historic preservation, archaeological surveys, historic maps, GIS data, etc.

N/A

- d. Proposed measures to avoid, minimize, or compensate for loss, changes to, and disturbance to resources. Please include plans for the above and any permits that may be required.

N/A

## 14. Transportation

- a. Identify public streets and highways serving the site or affected geographic area and describe proposed access to the existing street system. Show on site plans, if any.

Site marked with red pin.

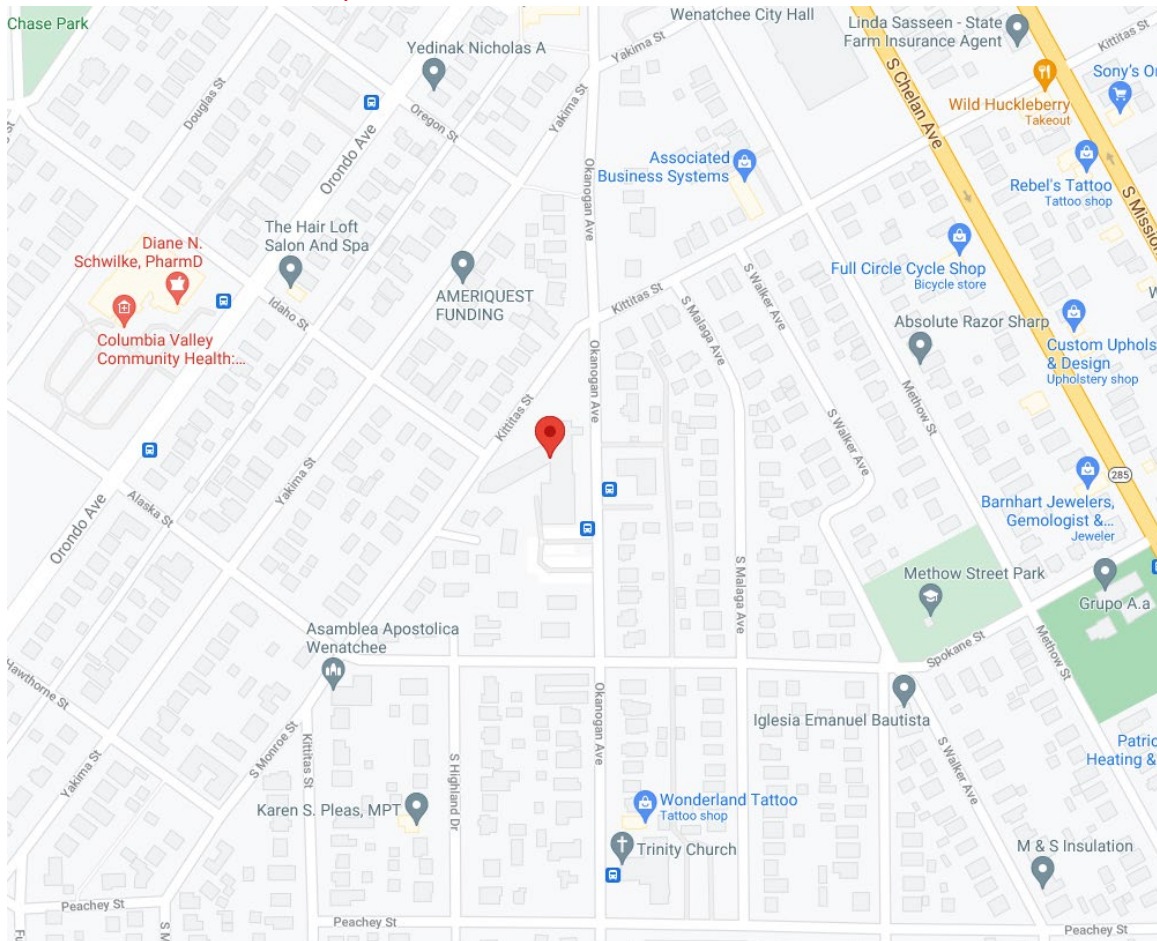

- b. Is the site or affected geographic area currently served by public transit? If so, generally describe. If not, what is the approximate distance to the nearest transit stop?

Yes, there is a bus stop in the immediate vicinity.

- c. How many additional parking spaces would the completed project or non-project proposal have? How many would the project or proposal eliminate?

None, the existing parking spaces will not change

- d. Will the proposal require any new or improvements to existing roads, streets, pedestrian, bicycle or state transportation facilities, not including driveways? If so, generally describe (indicate whether public or private).

No

- e. Will the project or proposal use (or occur in the immediate vicinity of) water, rail, or air transportation? If so, generally describe.

No

f. How many vehicular trips per day would be generated by the completed project or proposal? If known, indicate when peak volumes would occur and what percentage of the volume would be trucks (such as commercial and nonpassenger vehicles). What data or transportation models were used to make these estimates?

No increased trips from prior use. Residents primarily use public transportation.

g. Will the proposal interfere with, affect or be affected by the movement of agricultural and forest products on roads or streets in the area? If so, generally describe.

N/A

h. Proposed measures to reduce or control transportation impacts, if any:

N/A

15. Public Services

a. Would the project result in an increased need for public services (for example: fire protection, police protection, public transit, health care, schools, other)? If so, generally describe.

No

b. Proposed measures to reduce or control direct impacts on public services, if any.

N/A

16. Utilities

a. Highlight in Red utilities currently available at the site:

electricity, natural gas, water, refuse service, telephone, sanitary sewer, septic system, other \_\_\_\_\_

b. Describe the utilities that are proposed for the project, the utility providing the service, and the general construction activities on the site or in the immediate vicinity which might be needed.

No new utilities proposed. Existing utilities:  
Electrical – Chelan County PUD  
Water/sewer/storm – Chelan County PUD  
Fiber – Chelan County PUD

C. Signature

The above answers are true and complete to the best of my knowledge. I understand that the lead agency is relying on them to make its decision.

Signature: 

Name of signee: Eric Heintz

Position and Agency/Organization: Environmental Manager, Department of Corrections

Date Submitted: 12 August 2021